



Materials :

Connector part	Material	Finish
Bodies	Brass	Nickel or Gold
Center Contact	Male: Brass Female: Beryllium copper	Gold
Insulator	Teflon	N/A
Crimp ferrule	Annealed copper	Nickel or Gold

Electrical :

Electrical Data	Detail		
Impedance	50 ohm		
Frequency range	0~3 GHz		
Working voltage	250 volts rms max.		
Insulation resistance	1,000 megohms min.		
Contact resistance	Center contact: 6 milliohms max. Outer contact: 1.5 milliohms max.		
VSWR: f (GHz)		Straight	Right angle
	RG178/U	1.25+0.020f	1.25+0.030f
	RG174, 316/U	1.30+0.020f	1.30+0.030f
	RG405 (.085")	1.25+0.015f	1.25+0.025f
Insertion loss	0.3dB max.		

Mechanical :

Mechanical Data	Detail
Engagement force	8 lbs max.
Disengagement force	2 inch-pound min.
Connector durability	500 cycles min.
Contact retention	2 lbs min. axial force

Environmental :

Environmental Data	Detail
Corrosion (Salt spray)	MIL-STD-202 METHOD 101 CONDITION B
Thermal shock	MIL-STD-202 METHOD 107 CONDITION B
Vibration	MIL-STD-202 METHOD 204 CONDITION B
Mechanical shock	MIL-STD-202 METHOD 213 CONDITION B
Temperature range	-65 to 165

SSMB

SSMB ANGLE JACK FOR CABLE TYPE

CRIMP FOR FLEXIBLE CABLE

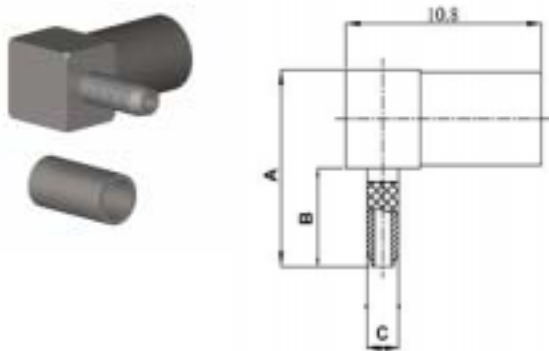

PART NUMBER	A	B	C	CABLE TYPE(RG/U)
SSMB-02LV1-TGG	10	5	2.6	174, 188A, 316
SSMB-02M-TGG	10	5	2	178, 196

SOLDER FOR SEMI-RIGID CABLE

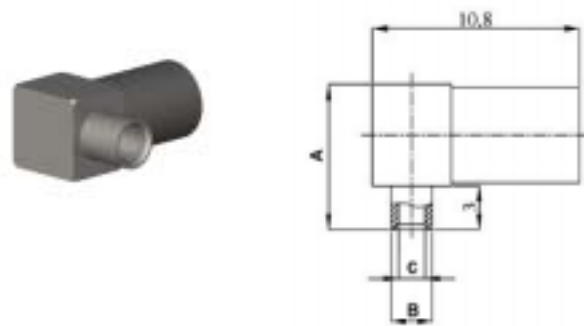

PART NUMBER	A	B	C	CABLE TYPE(RG/U)
SSMB-02V1-TGG	8	3	2.3	RG405U(.085")
SSMB-02V3-TGG	8	2.2	1.35	UT-47(.047")

SSMB ANGLE PLUG FOR CABLE TYPE

CRIMP FOR FLEXIBLE CABLE

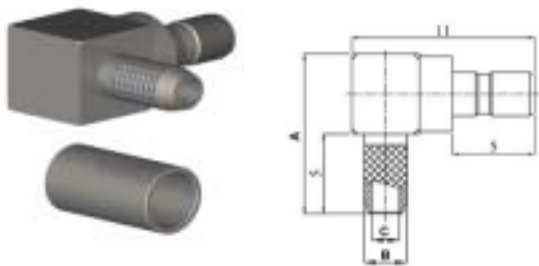

PART NUMBER	A	B	C	CABLE TYPE(RG/U)
SSMB-04LV1-TGG	10	2.6	1.7	174, 188A, 316
SSMB-04M-TGG	10	2	1	178, 196

SOLDER FOR SEMI-RIGID CABLE

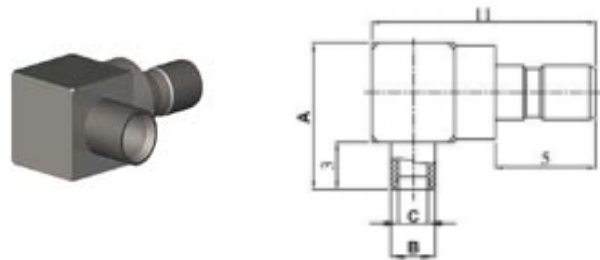

PART NUMBER	A	B	C	CABLE TYPE(RG/U)
SSMB-04V1-TGG	8	3	2.3	RG405U (.085")
SSMB-04V3-TGG	8	2.2	1.35	UT-47 (.047")

SSMB STRAIGHT JACK FOR CABLE TYPE

CRIMP FOR FLEXIBLE CABLE

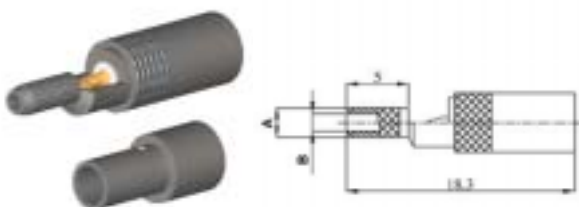

PART NUMBER	A	B	C	CABLE TYPE(RG/U)
SSMB-01LV1-TGG	2.7	1.7	174, 188A, 316	
SSMB-01M-TGG	2	1	178, 196	

SSMB STRAIGHT PLUG FOR CABLE TYPE

CRIMP FOR FLEXIBLE CABLE

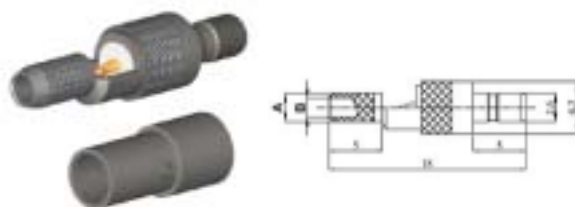

PART NUMBER	A	B	C	CABLE TYPE(RG/U)
SSMB-03LV1-TGG	2.7	1.7	174, 188A, 316	
SSMB-03M-TGG	2	1	178, 196	

TGN : IEFロン INSULATION + GOLD PLATED CONTACT + NICKEL PLATED BODY
 TGG : IEFロン INSULATION + GOLD PLATED CONTACT + GOLD PLATED BODY